

NOTES: Approx. Weight: 285.82 lbs

--- Bend down  
 --- Bend up

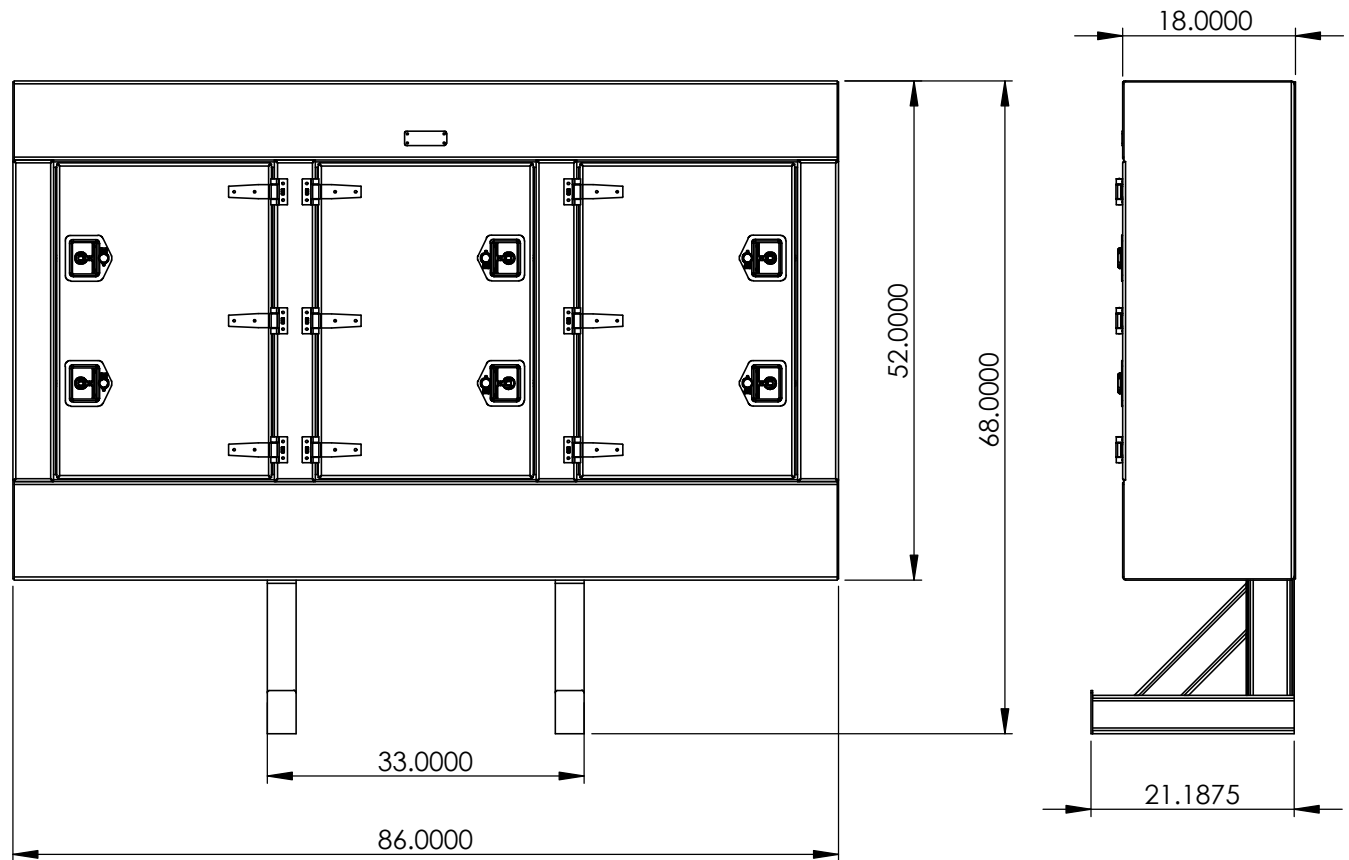
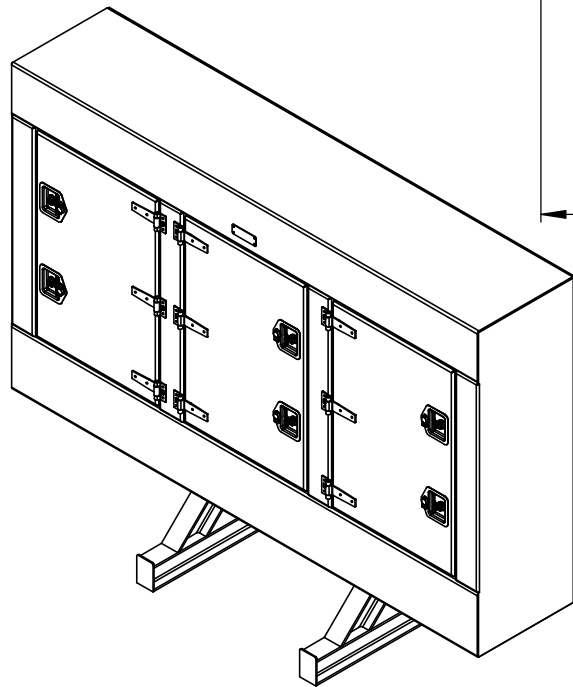

**P/N: 1311**

DWG. NO.: 505-866818-000-A

MATERIAL: 5052 (Alum)

THICKNESS: 0.125

FINISH: Smooth

Drawn By  
 Date Drawn  
 Checked By

**PROPRIETARY AND CONFIDENTIAL**

NO PART OF THIS DOCUMENT MAY BE REPRODUCED, STORED IN A RETRIEVAL SYSTEM, OR TRANSMITTED IN ANY FORM, WITHOUT THE WRITTEN PERMISSION OF Iconic Elements Inc.

**ICONIC ELEMENTS**

UNLESS OTHERWISE SPECIFIED: DIMENSIONS ARE IN INCHES  
 TOLERANCES: X/X±1/16" .XX±.01" .XXX±.005"

TITLE:

Headache Rack

REV: A  
 SHEET: 1 OF 2

5

4

3

2

1

NOTES:

- — — Bend down
- - - Bend up

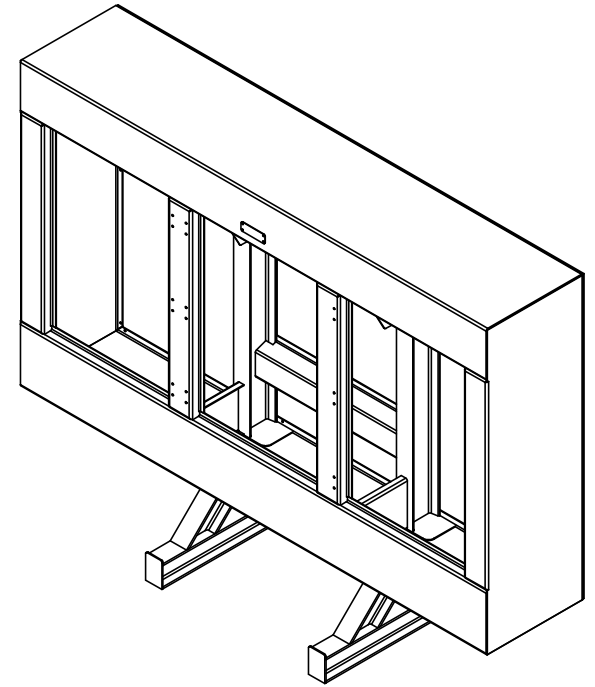
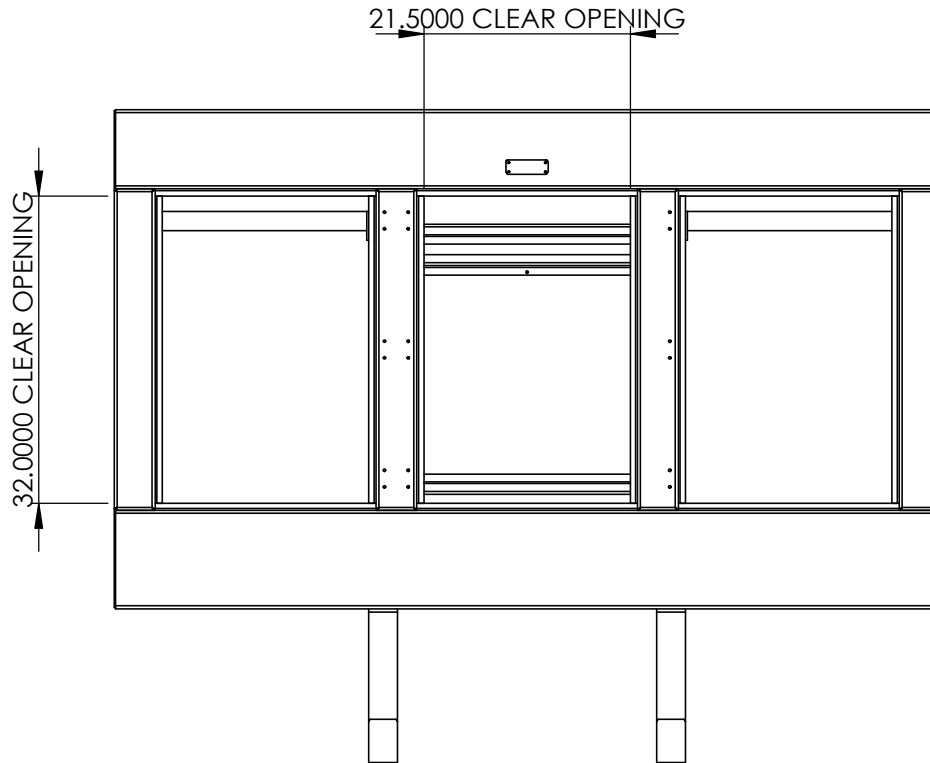

DWG. NO.: 505-866818-000-A

MATERIAL: 5052 (Alum)

THICKNESS: 0.125

FINISH: Smooth

Drawn By  
Date Drawn  
Checked By

**PROPRIETARY AND CONFIDENTIAL**

NO PART OF THIS DOCUMENT MAY BE REPRODUCED, STORED IN A RETRIEVAL SYSTEM, OR TRANSMITTED IN ANY FORM, WITHOUT THE WRITTEN PERMISSION OF Iconic Elements Inc.

**ICONIC ELEMENTS**

UNLESS OTHERWISE SPECIFIED: DIMENSIONS ARE IN INCHES  
TOLERANCES: X/X±1/16" .XX±.01" .XXX±.005"

TITLE:

Headache Rack

REV:

A

SHEET:

2 OF 2

5

4

3

2

1